

# P2C3 Raspberry Pi B+/2B and case Installation Instructions

## Raspberry Pi Installation Instructions

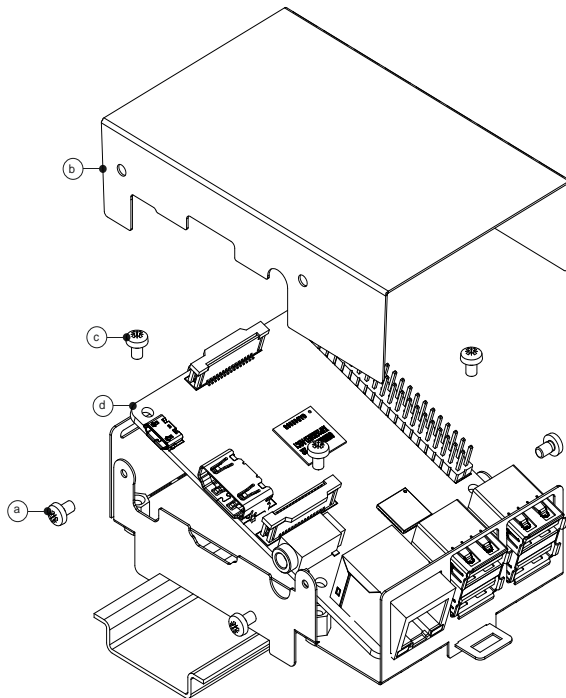

- Step 1:** Unscrew outer screws **a** and remove cover **b**;
- Step 2:** Unscrew inner screws **c**;
- Step 3:** Insert Raspberry Pi **d** Ethernet and USB connectors first as shown on the picture;
- Step 4:** Replace inner screws **c**, cover **b**, and outer screws **a**.  
Be careful when replacing outer screws and do not overtighten them!

## Entire assembly Installation Instructions

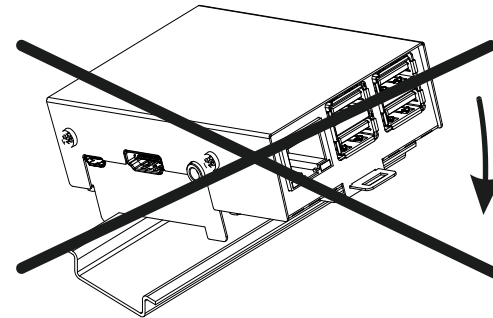

Please **DO NOT** press the case against the DIN rail until it clicks in place!

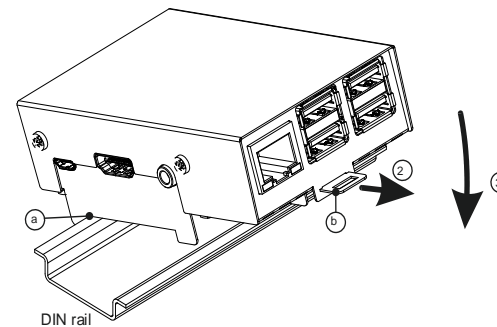

- Step 1:** Attach the rear hook **a** to the DIN rail.
- Step 2:** Pull the DIN rail lock **b** until it stops.
- Step 3:** Press the case against the DIN rail and release the lock **b**.

---

**Disclaimer:** All information in this document is provided in connection with embeddedglow.com products. No license, express or implied, by estoppel or otherwise, to any intellectual property right is granted by this document or in connection with the sale of embeddedglow.com products. **EXCEPT AS SET FORTH IN EMBEDDEDGLOW.COM TERMS AND CONDITIONS OF SALE, WEBSITE OWNER ASSUMES NO LIABILITY WHATSOEVER AND DISCLAIMS ANY EXPRESS, IMPLIED OR STATUTORY WARRANTY RELATING TO HIS PRODUCTS INCLUDING, BUT NOT LIMITED TO, THE IMPLIED WARRANTY OF MERCHANTABILITY, FITNESS FOR A PARTICULAR PURPOSE, OR NON-INFRINGEMENT. IN NO EVENT WILL WEBSITE OWNER BE LIABLE FOR ANY DIRECT, INDIRECT, CONSEQUENTIAL, PUNITIVE, SPECIAL OR INCIDENTAL DAMAGES, INCLUDING WITHOUT LIMITATION, DAMAGES FOR LOSS OF PROFITS, BUSINESS INTERRUPTION, OR LOSS OF INFORMATION, ARISING OUT OF THE USE OR INABILITY TO USE THIS DOCUMENT.**

Website owner makes no representations or warranties with respect to the accuracy or completeness of the contents of this document and reserves the right to make changes to specifications and product descriptions at any time without notice. Website owner does not make any commitment to update the information contained herein.

Embeddedglow.com products are not intended, authorized, or suitable for, and shall not be used in automotive applications and/or as components in applications intended to support or sustain life.

The content of this document is protected by Copyright. It cannot be copied or distributed in any way without the permission of the copyright holder. All rights are reserved.